



# T&S BRASS AND BRONZE WORKS, INC.

2 Saddleback Cove / P.O. Box 1088  
Travelers Rest, SC 29690



REG. #A2601  
ISO #9001

Model No.  
**B-0892-133X**

Item No.

Travelers Rest, SC: 800-476-4103 Simi Valley, CA: 800-423-0150 Fax: 864-834-3518 www.tsbrass.com

This Space for Architect/Engineer Approval

Job Name \_\_\_\_\_ Date \_\_\_\_\_

Model Specified \_\_\_\_\_ Quantity \_\_\_\_\_

Customer/Wholesaler \_\_\_\_\_

Contractor \_\_\_\_\_

Architect/Engineer \_\_\_\_\_

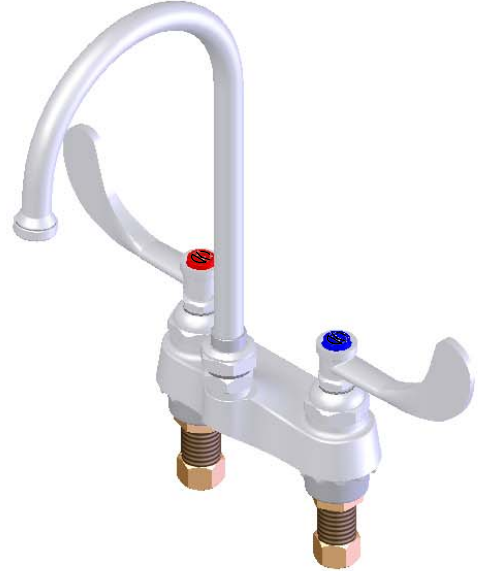

- Variations or Applicable Options:
- WH6 6" Wrist Action Handles
  - 177F Lever Handles
  - 175F 4-Arm Kitchen Handles



ADA COMPLIANT

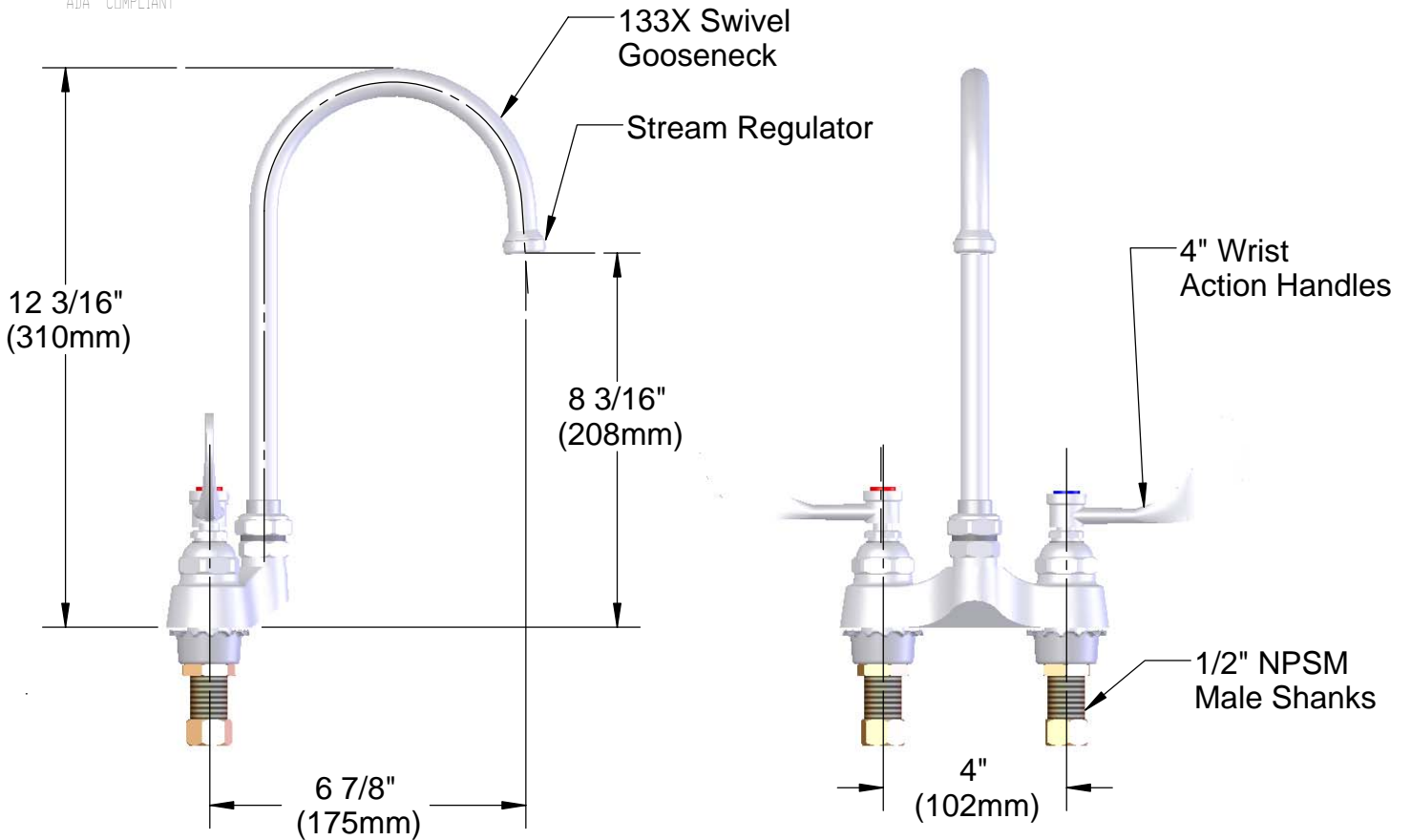

Product Specifications:  
 4" Centerset Mixing Faucet, w/ 1/2" NPSM Male Shanks,  
 Eterna Cartridges, 4" Wrist Action Handles,  
 Swivel Gooseneck, Stream Regulator

|               |                |                    |
|---------------|----------------|--------------------|
| Drawn<br>WJS  | Checked<br>JRM | Approved<br>JHB    |
| Scale:<br>1:4 |                | Date:<br>3/13/2006 |



**T&S BRASS AND BRONZE WORKS, INC.**

2 Saddleback Cove / P.O. Box 1088  
Travelers Rest, SC 29690



REG. #A2601  
ISO #9001

Model No.  
**B-0892-133X**

Item No.

Travelers Rest, SC: 800-476-4103 Simi Valley, CA: 800-423-0150 Fax: 864-834-3518 www.tsbrass.com

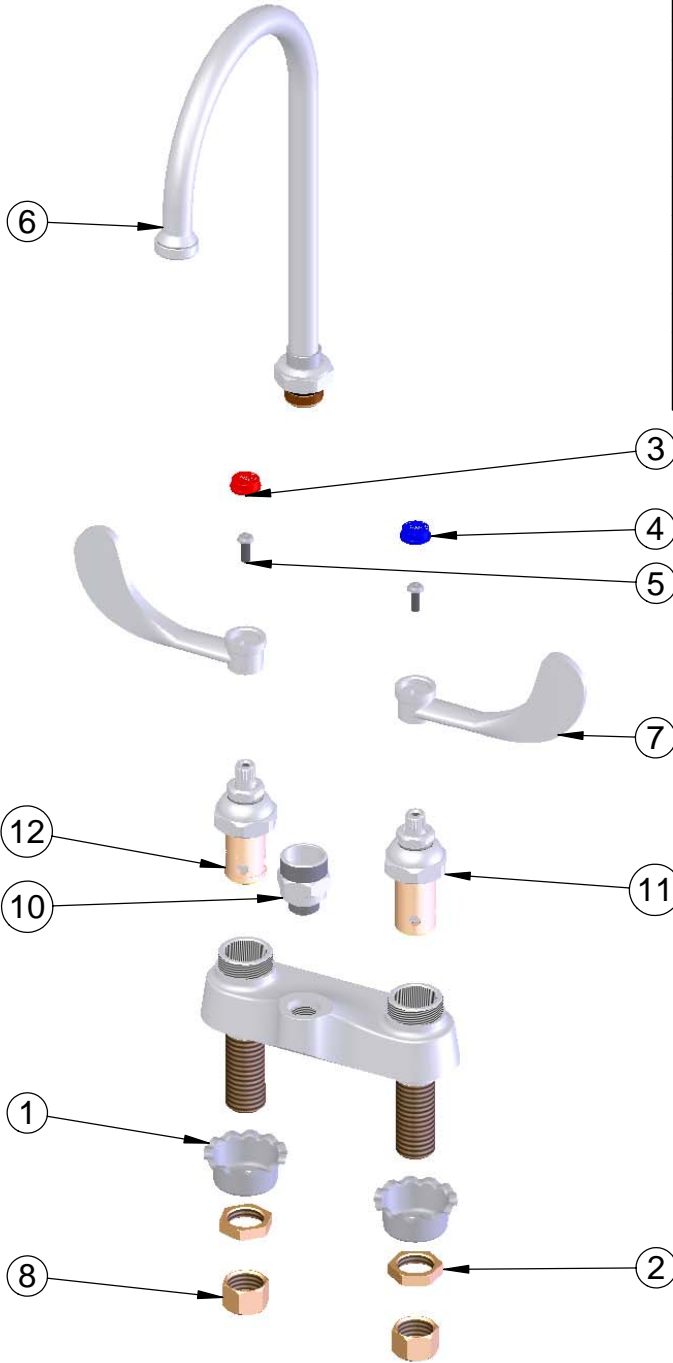

| ITEM NO. | SALES NO. | DESCRIPTION             |
|----------|-----------|-------------------------|
| 1        | 001000-45 | Rosette Washer          |
| 2        | 002954-45 | Shank Lock Nut          |
| 3        | 001194-45 | Red HW Index            |
| 4        | 001686-45 | Blue CW Index           |
| 5        | 000925-45 | Lab Handle Screw        |
| 6        | 133X      | 133X Swivel Gooseneck   |
| 7        | B-WH4     | 4" Wrist Action Handle  |
| 8        | 000958-20 | Coupling Nut            |
| 10       | B-0412    | Rigid to Swivel Adapter |
| 11       | 006009-40 | Cold Spindle Asm        |
| 12       | 006010-40 | Hot Spindle Asm         |

Product Specifications:

4"Centerset Mixing Faucet, w/ 1/2" NPSM Male Shanks, Eterna Cartridges, 4" Wrist Action Handles, Swivel Gooseneck, Stream Regulator

|               |                |                    |
|---------------|----------------|--------------------|
| Drawn<br>WJS  | Checked<br>JRM | Approved<br>JHB    |
| Scale:<br>1:4 |                | Date:<br>3/13/2006 |